

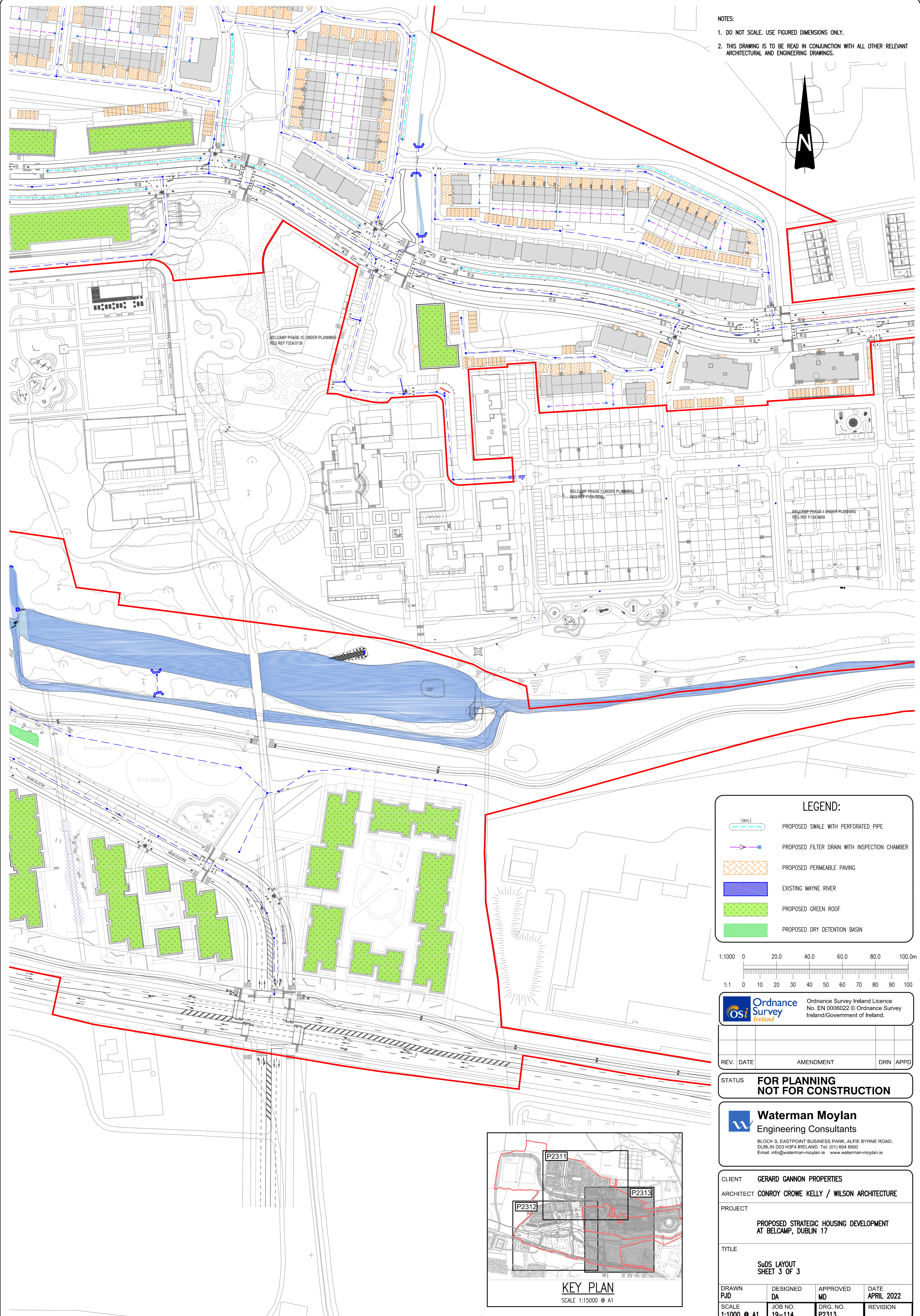

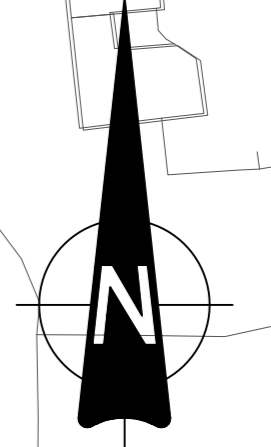

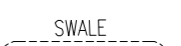

NOTES:

- DO NOT SCALE. USE FIGURED DIMENSIONS ONLY.
- THIS DRAWING IS TO BE READ IN CONJUNCTION WITH ALL OTHER RELEVANT ARCHITECTURAL AND ENGINEERING DRAWINGS.



LEGEND:

-  PROPOSED SWALE WITH PERFORATED PIPE
-  PROPOSED FILTER DRAIN WITH INSPECTION CHAMBER
-  PROPOSED PERMEABLE PAVING
-  EXISTING MAYNE RIVER
-  PROPOSED GREEN ROOF
-  PROPOSED DRY DETENTION BASIN

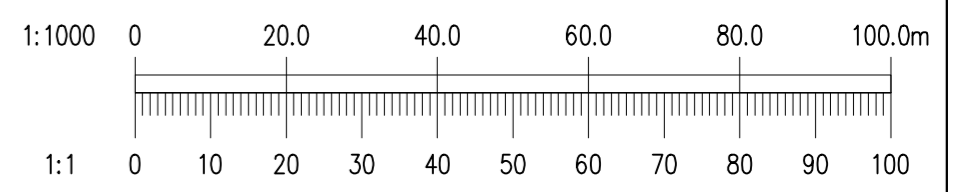

REV.	DATE	AMENDMENT	DRN	APPD

STATUS **FOR PLANNING NOT FOR CONSTRUCTION**

Waterman Moylan
Engineering Consultants

BLOCK 5, EASTPOINT BUSINESS PARK, ALFIE BYRNE ROAD,
DUBLIN D03 H3F4 IRELAND. Tel: (01) 664 8900
Email: info@waterman-moylan.ie www.waterman-moylan.ie

CLIENT **GERARD GANNON PROPERTIES**

ARCHITECT **CONROY CROWE KELLY / WILSON ARCHITECTURE**

PROJECT **PROPOSED STRATEGIC HOUSING DEVELOPMENT AT BELCAMP, DUBLIN 17**

TITLE **SuDS LAYOUT SHEET 3 OF 3**

DRAWN PJD	DESIGNED DA	APPROVED MD	DATE APRIL 2022
SCALE 1:1000 @ A1	JOB NO. 19-114	DRG. NO. P2313	REVISION

